

ILLUSION 650 WALL-HUNG BASIN

CAT. NO
4-1741WH



Faucet not included



Mounting hardware

W: 25-3/4"
D: 17-3/8"
H: 6-1/2"

Interior Dimensions:

Basin interior:	11-3/4" x 22-1/2"
Basin depth:	5"
Faucet hole:	1-1/2"
Back of basin to center of faucet:	2-3/8"
Back of basin to center of drain:	8"
Mount holes cc:	10"
Water depth to overflow:	2-1/2"
Drain hole:	1-3/4"

Features:

- ▶ Made of Vitreous China
- ▶ Available for 1 hole (4-1741WH) and (4-1744WH)
- ▶ Overflow
- ▶ Mounting hardware included

Colors:

WH White

Meets or exceeds the following specifications: ASME A112.19.2 2018 and CSA B45.1-18 for ceramic plumbing fixtures.

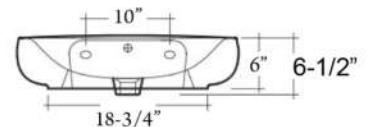
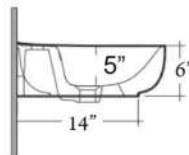
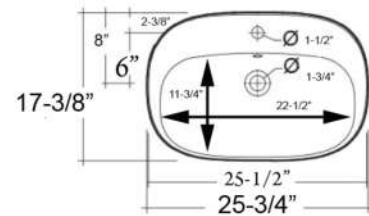

Dimensions of fixture are nominal and may vary within the range of tolerances established by ASME Standard A112.19.2. Dimensions and specifications subject to change without notice.